

# TORQLITE

## RT, RTS & RT24-STJ SERIES

RISER TOOL WRENCH

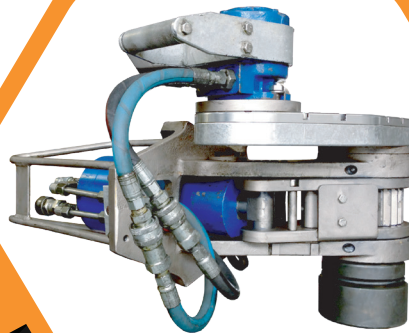

# TORQLITE RT SERIES



Our patented RT Series riser tool is a hydraulic speed/torque wrench combination, designed for use during make-up or breakout of any sub-sea riser bolted flange.

With the push of a hand-held button, the RT Series riser tool spins the bolt down at high speed and then automatically completes the torque to a preset limit when making up.

When breaking out, the tool does the exact opposite, using the ratcheting operation to break the bolt loose and then automatically spins it out at high speed.

## **FAST**

The riser tools make up or break out a single riser bolt in seconds. This greatly reduces operating time during bolting and saves money.

## **HANDS FREE**

The RT Series switches from run-down mode to torquing mode automatically. Using the handheld remote push button allows operators to use the riser tools without any need for manual adjustment, making them completely hands-free, and creating an absolute-safe environment.

## **EXTREME TORQUE**

The three models of tools give you a wide range of torque capability, but with a maximum torque capacity of 35,250 ft./lbs., you can be sure your bolts are secure and that they are able to be broken out when the time comes.

## **SQUARE DRIVE**

The 2½" square drive can be used with multiple standard-size square drive impact sockets or in-house modified specialty sockets. It easily converts from make-up to break-out allowing effective use of the tools for either application.

## **REACTION BAR**

The RT Series has three possible reaction bars, each designed for different types of riser. We offer inline reaction bars that react off of the riser, drop down reaction bars that react off of the flange, and Load King reaction bars specifically designed for Load King riser.

## **COMPLETE PACKAGE**

Available with our dual-control console, sockets, and overhead spring balancers that can be used to reduce the weight of the tool to as low as one pound.

## **CALIBRATED**

Every tool is tested and calibrated to +/- 3% accuracy, traceable to N.I.S.T.

## **CAST BODY**

One piece cast steel body. Each body is checked for hardness and specific material verified by a metallurgist. Then each body is x rayed to ensure there are no flaws in the material. Lastly, the body is CNC Machined to exact tolerances needed for the TorqLite Riser Tool to perform safely at the highest level of quality, durability, and accuracy.

## **NICKEL COATING**

Resists corrosion.

# TORQLITE RT SERIES

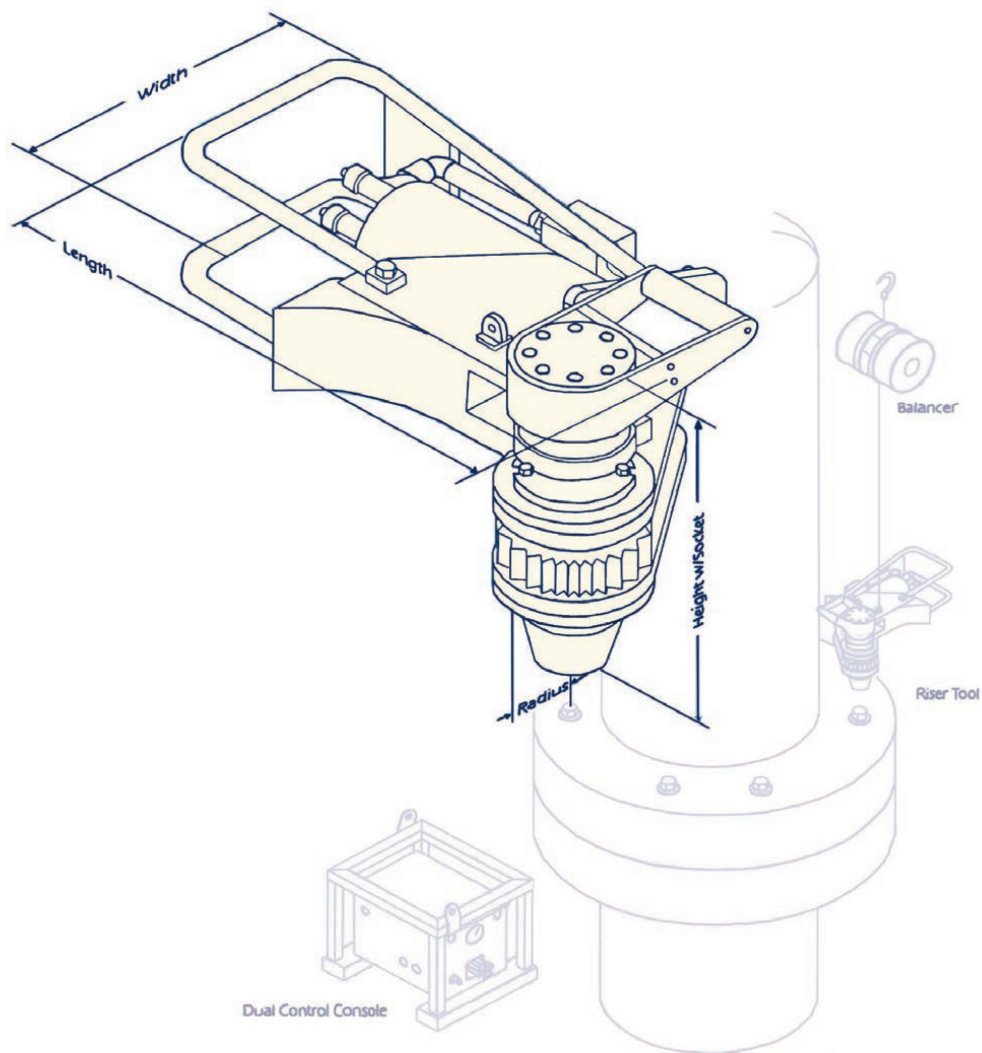

RT SERIES	MAX FT. LBS. @ 3,000 PSI	LENGTH	HEIGHT W/ SOCKET	WIDTH W/ GEARBOX	WIDTH	RADIUS	SQUARE DRIVE	WEIGHT
RT- 16	16,234	26.34"	14.42"	11.50"	20.28"	3.10"	2.5"	230 lbs.
RT- 24	25,453	26.34"	14.42"	11.50"	20.28"	3.10"	2.5"	235 lbs.
RT- 40	35,250	36.50"	17.35"	13.66"	20.50"	3.10"	2.5"	258 lbs.

**This tool is approved for explosive environments**



# TORQLITE RT-S SERIES

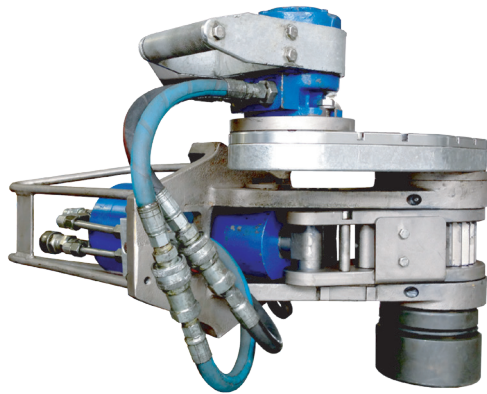

TorqLite's RT-S Series riser tool is a modified version of the standard RT Series. It is specifically designed to tighten and loosen bolts on Shaffer FT-H and FT-G 8-bolt riser.

With the push of a hand-held button, the RT Series riser tool spins the bolt down at high speed and then automatically completes the torque to a present limit when making up.

When breaking out, the tool does the exact opposite using the ratcheting operation to break the bolt loose and then spinning it out at high speed.

**All tool functionality and benefits are the same as the RT-Series**



# TORQLITE RT-S SERIES

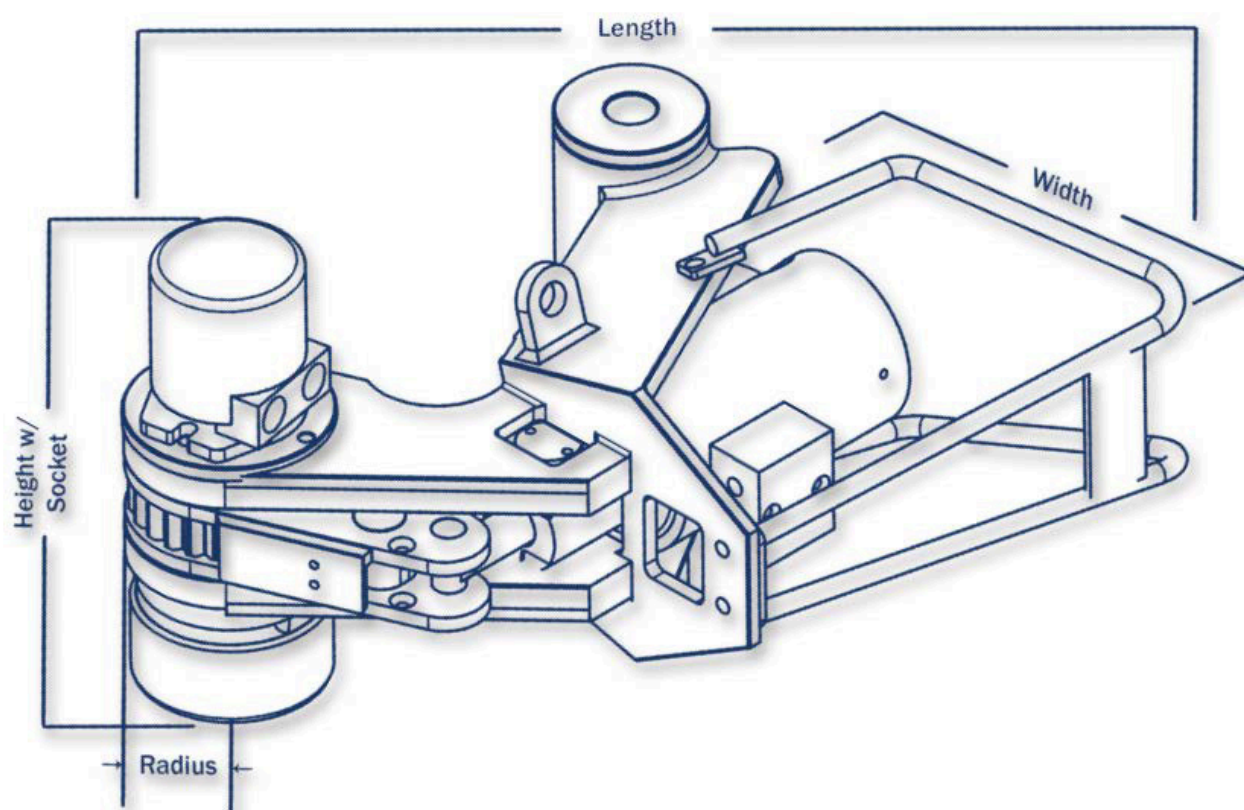

RT SERIES	MAX FT. LBS. @ 3,000 PSI	LENGTH	HEIGHT W/ SOCKET	WIDTH W/ GEARBOX	WIDTH	RADIUS	SQUARE DRIVE	WEIGHT
RT- 16s	16,234	26.34"	14.42"	11.50"	20.28"	3.10"	2.5"	230 lbs.
RT- 24s	25,453	26.34"	14.42"	11.50"	20.28"	3.10"	2.5"	235 lbs.
RT- 40s	35,250	36.50"	17.35"	13.66"	20.50"	3.10"	2.5"	258 lbs.

**This tool is approved for explosive environments**

# TORQLITE RT24-STJ SERIES



The TorqLite RT24-STJ has been specifically modified to fit on FT-HB, HFGN, DG telescopic joint assemblies with no barrel interference.

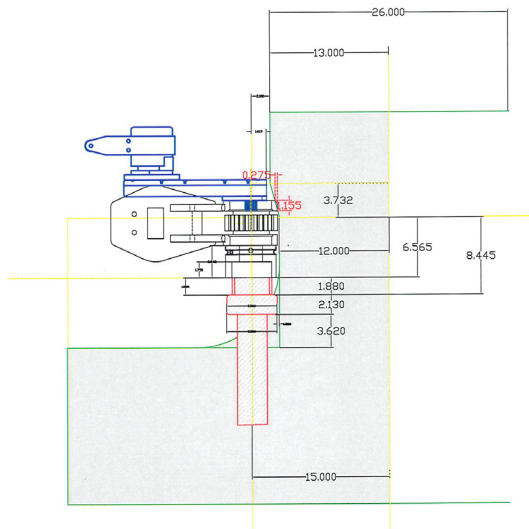

The drive gear is modified to have a smaller width

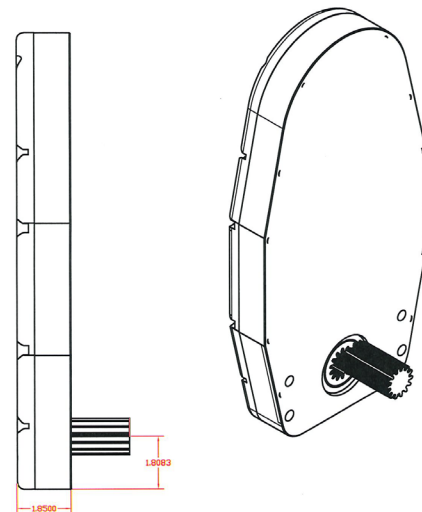

The nose of the gearbox is machined down to fit in the upset of the TJ

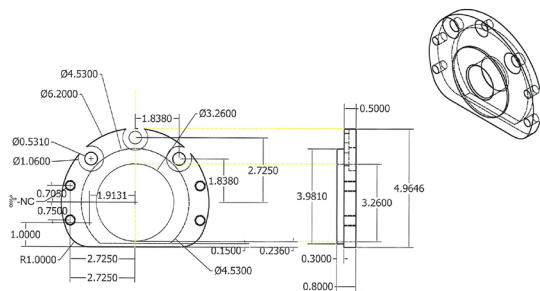

The motor plate for the gearbox is machined down to fit in the upset of the TJ

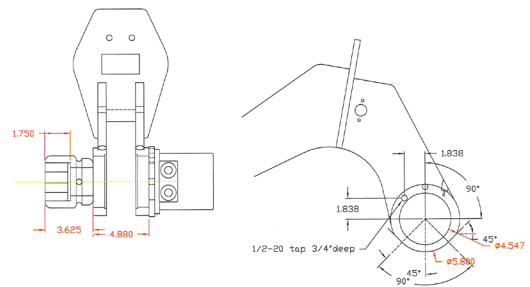

The nose of the RTS body is machined / tapered to fit the upset of the TJ



# TORQLITE RT24-STJ SERIES

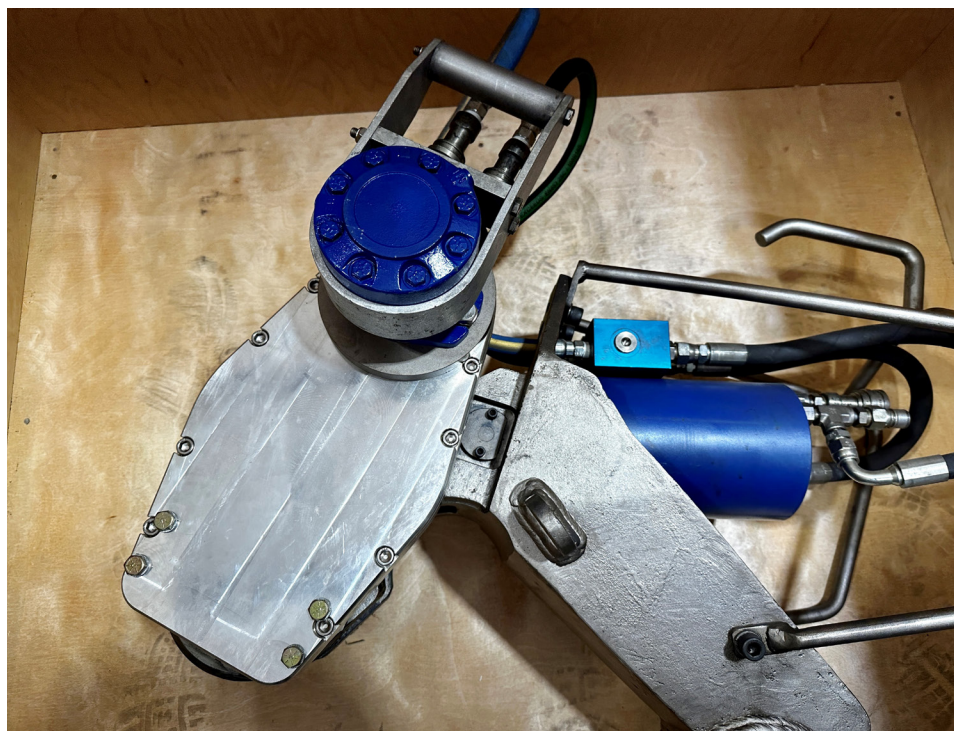
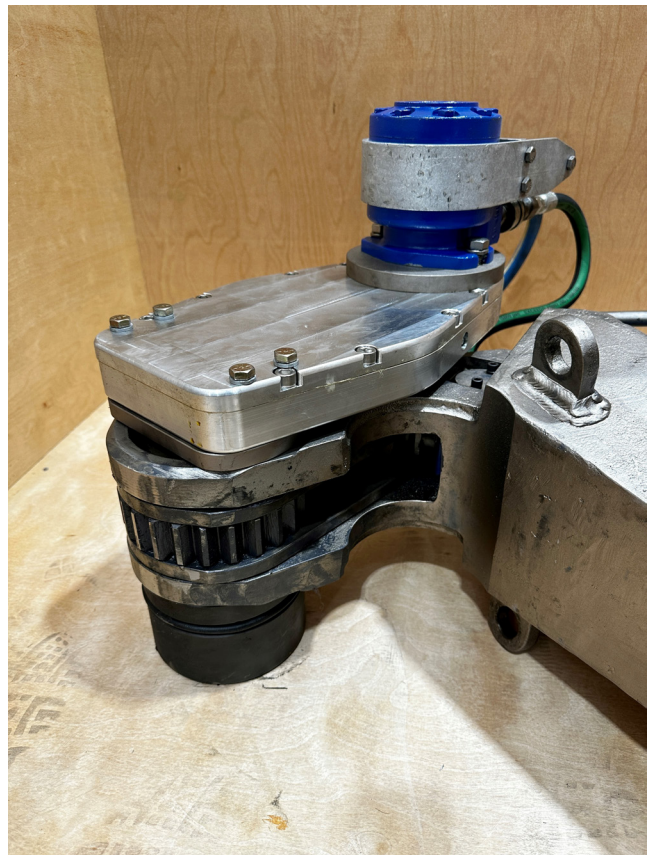



# TORQLITE RT ACCESSORIES



**DCC** Custom-built, aluminum dual-control conversion console, utilizes rig hydraulics up to 3,000 p.s.i. and provides continuous volume of hydraulic fluid required to independently operate two riser tools simultaneously.

## SPRING BALANCERS

By using the overhead spring balancers, you can virtually eliminate the weight of riser tool, which reduces operator fatigue and increases efficiency of operation. The balancers are adjustable so that you can use them to your specifications.

## SOCKETS

We stock all standard-size sockets and we can also modify sockets in-house to fit any of your particular needs for your application.

## OIL STORAGE

All riser tool packages include a divided and compartmentalized aluminum container for storage and submerging of riser tools with self-standing lockable lids.

## TOOLS

RT & RTS-16: Torque up to 16,234 ft./lbs.  
RT & RTS-24: Torque up to 25,453 ft./lbs.  
RT & RTS-40: Torque up to 35,250 ft./lbs.





# TORQLITE RT ACCESSORIES

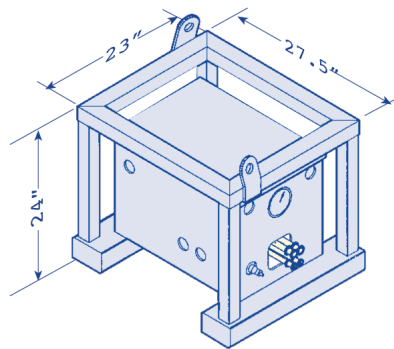

MODEL	MAX. OUTPUT	FLUID CAPACITY	AIR REQ.	CONTROL	HYDRAULIC HOSES	WEIGHT W/ HOSES	WIDTH	LENGTH	HEIGHT
DCC	3000 psi	40 GPM of Rig Hydraulics	90 psi 20 cfm	(2) Push Button	(4) 30 ft. x 3/8" 5000 psi WP	206 lbs.	23"	27.5"	31.75"

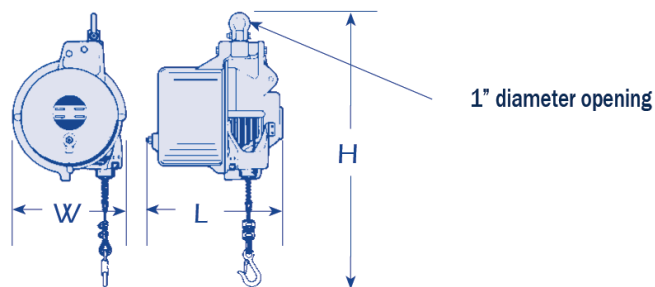

MODEL	CABLE TRAVEL	LENGTH	WIDTH	HEIGHT	CAPACITY	WEIGHT
16B125/ 24B125	5 ft.	8"	9.5"	16" min.	220-275 lbs.	39 lbs.
40B170	5 ft.	8"	11"	24"	308-375 lbs.	62 lbs.

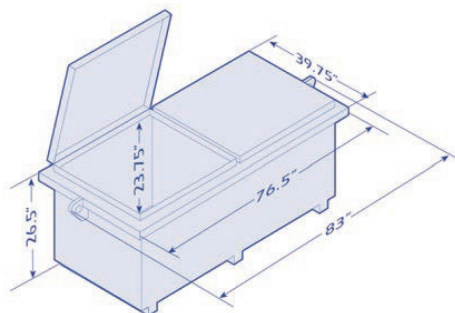

LENGTH	LENGTH W/ EYELITS	DEPTH	WIDTH	HEIGHT	CAPACITY
76.5"	83"	39.75"	26.5"	23.75"	150 lbs.



**Inline Reaction Member**  
Reacts off of the riser

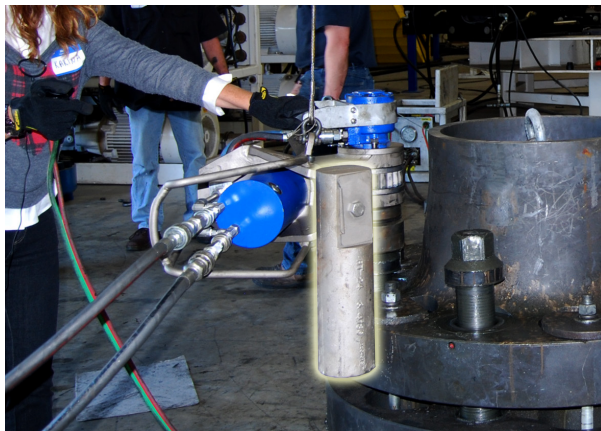

**RT Drop Down Reaction Member**  
Reacts off of the flange

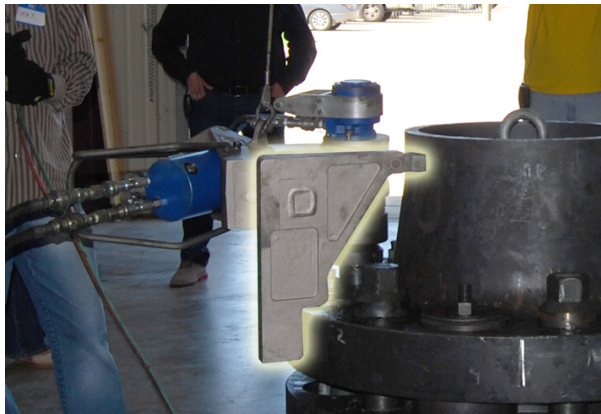

**Load King Reaction Member**  
Specifically designed for the Load King riser

# TORQLITE

**Call or email for more  
information or to get a quote**

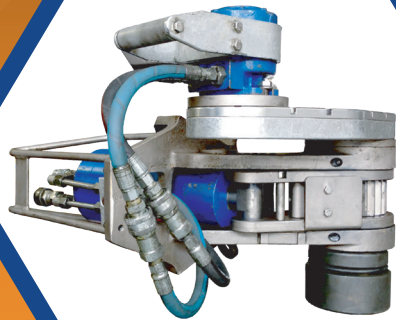

**5335 Brystone Drive,  
Houston TX 77041  
713-983-7171**

**sales@torqlite.com  
torqlite.com**