

STANDARD RANGE HYDRAULIC BOLT TENSIONING TOOLS

TorqLite's T-Series hydraulic bolt tensioners are a standard range designed for general use on topside applications.



SPECIFICATION

Designed to fit most ANSI B16.5, MSS SP-44 and API17D flanges.

Compatible with imperial and metric bolts from 3/4" - 4" (M16 – M100).

1500 bar maximum working pressure.

Each tool comprises of a hydraulic cylinder, bridge, puller and socket.

Interchangeable adaptor kits fit a common hydraulic cylinder capable of tightening multiple bolt sizes.

BENEFITS

- High wear and corrosion resistant surface treatment.
- Internal features to compensate for joint misalignment.
- Tools can be connected in sequence improving operation speed and ensuring even joint compression.
- Available from stock.



TorqLite has developed an Augmented Reality experience for this product. To view this experience please download the Vuforia View App and scan the mark below

Hydraulic oil flows into load cell

Load generated by load cell is transferred into the puller

Puller transfers the load directly into the bolt

The nut lifts clear of the flange surface due to bolt stretch

The socket is used to turn the nut down retaining the load

TECHNICAL & DIMENSIONAL DATA

- Nut height is assumed 1 x Bolt Diameter.
- All tools are 15 mm stroke except Tool No. 21 which is 12 mm.
- Thread pitch for metric bolt sizes will be metric coarse.
- Thread pitch for imperial bolt sizes will be UNC up to 1 inch and UN8 for 1-1/8 inch upwards.

Tool No. & Spec.			Bolt Diameter		Min. Bolt Pitch		Weights		
			mm	in	mm	in	Component	kg	lbs
Tool #	21		M16	-	53	2.1	Full Tool	2.3	5.0
Hydraulic Area	1555 mm ²	2.41 in ²	M20	3/4	53	2.1	Cylinder	1.1	2.4
Max. Load	233 kN	52.4 klbf	M22	7/8	53	2.1	Bridge	0.4	0.8
Tool Outside Dia.	73 mm	2.9 in	M24	1	62	2.4	Puller	0.7	1.5
Nearest Obstruction	145 mm	5.7 in	M27	1-1/8	62	2.4	Socket	0.1	0.2
Tool Height	102 mm	4.0 in	-	-	-	-	-	-	-
Tool #	22		M27	1-1/8	62	2.4	Full Tool	5.7	12.4
Hydraulic Area	2884 mm ²	4.47 in ²	M30	1-1/4	73	2.9	Cylinder	2.8	6.2
Max. Load	433 kN	97.3 klbf	M33	-	73	2.9	Bridge	1	2.2
Tool Outside Dia.	105 mm	4.1 in	M36	1-3/8	81	3.2	Puller	1.7	3.7
Nearest Obstruction	175 mm	6.9 in	M39	1-1/2	83	3.3	Socket	0.15	0.3
Tool Height	131 mm	5.2 in	-	-	-	-	-	-	-
Tool #	23		M39	1-1/2	83	3.3	Full Tool	9.6	21.1
Hydraulic Area	5271 mm ²	8.17 in ²	M42	1-5/8	93	3.7	Cylinder	4.1	9.0
Max. Load	791 kN	177.8 klbf	M45	1-3/4	96	3.8	Bridge	2	4.4
Tool Outside Dia.	136 mm	5.4 in	M48	1-7/8	101	4.0	Puller	3.2	7.0
Nearest Obstruction	200 mm	7.9 in	M52	2	104	4.1	Socket	0.3	0.7
Tool Height	147 mm	5.8 in	-	-	-	-	-	-	-
Tool #	24		M52	2	104	4.1	Full Tool	16.3	35.9
Hydraulic Area	8445 mm ²	13.09 in ²	M56	2-1/4	123	4.8	Cylinder	6.3	13.9
Max. Load	1267 kN	284.8 klbf	M64	2-1/2	129	5.1	Bridge	3.7	8.1
Tool Outside Dia.	172 mm	6.8 in	-	-	-	-	Puller	5.6	12.3
Nearest Obstruction	230 mm	9.1 in	-	-	-	-	Socket	0.7	1.5
Tool Height	168 mm	6.6 in	-	-	-	-	-	-	-
Tool #	25		M64	2-1/2	129	5.1	Full Tool	25.3	55.7
Hydraulic Area	12197 mm ²	18.91 in ²	M72	2-3/4	150	5.9	Cylinder	9.5	20.9
Max. Load	1830 kN	411.4 klbf	M76	3	154	6.1	Bridge	6.6	14.5
Tool Outside Dia.	200 mm	7.9 in	-	-	-	-	Puller	8.2	18.0
Nearest Obstruction	255 mm	10.0 in	-	-	-	-	Socket	1	2.2
Tool Height	188 mm	7.4 in	-	-	-	-	-	-	-
Tool #	26		M76	3	154	6.1	Full Tool	36.1	79.3
Hydraulic Area	16682 mm ²	25.86 in ²	M80	3-1/4	176	6.9	Cylinder	12.8	28.1
Max. Load	2502 kN	562.5 klbf	M90	3-1/2	185	7.3	Bridge	9.1	20.0
Tool Outside Dia.	235 mm	9.3 in	-	-	-	-	Puller	12.9	28.4
Nearest Obstruction	288 mm	11.3 in	-	-	-	-	Socket	1.3	2.9
Tool Height	212 mm	8.4 in	-	-	-	-	-	-	-
Tool #	27		M90	3-1/2	185	7.3	Full Tool	41.4	91.1
Hydraulic Area	17530 mm ²	27.17 in ²	M95	3-3/4	191	7.5	Cylinder	13.7	30.1
Max. Load	2629 kN	593.3 klbf	M100	4	197	7.8	Bridge	12.2	26.8
Tool Outside Dia.	245 mm	9.7 in	-	-	-	-	Puller	13.5	29.7
Nearest Obstruction	320 mm	12.6 in	-	-	-	-	Socket	2	4.4
Tool Height	227 mm	8.9 in	-	-	-	-	-	-	-

Items in orange are standard tools but are not held in stock. For price and delivery please contact the sales department

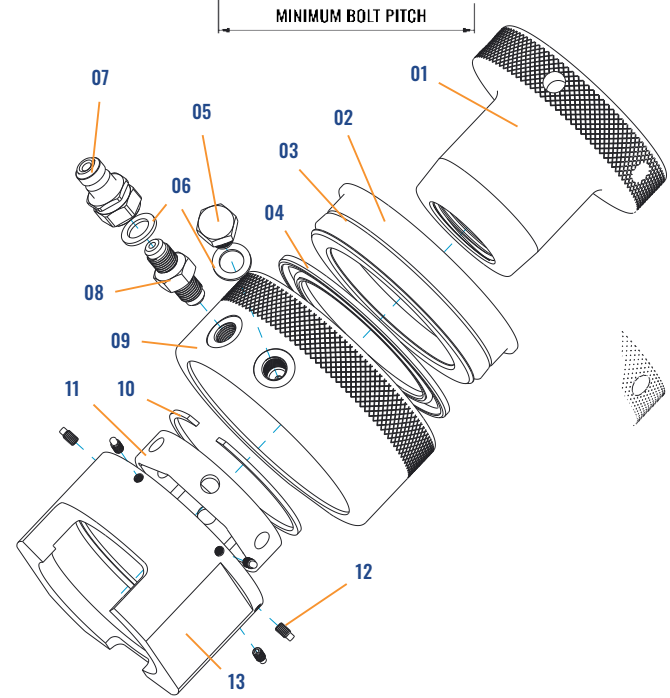
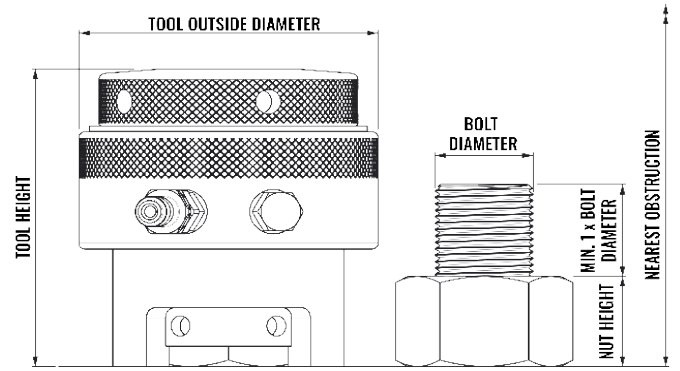

PART REFERENCE	DESCRIPTION
01	PULLER
02	PISTON
03	INDICATOR RING
04	SEAL KIT
05	BLANKING PLUG
06	BONDED WASHER SEAL (where applicable)
07	MALE QUICK CONNECTOR
08	MALE - MALE ADAPTOR
09	BODY
10	SNAP RING
11	SOCKET
12	GRUB SCREW
13	BRIDGE

Manufacturing, R&D, and Operations

Address: 8 Dufresne Loop Luling, LA 70070
Tel: 985-785-3075
Email: info@torqlite.com
www.torqlite.com

Sales Headquarters

Address: 5335 Brystone Dr. Houston, TX 77041
Tel: 713-983-7171
Email: sales@torqlite.com
www.torqlite.com

TORQLITE